

# CIP Training

L5160/L5130

**RICOH**  
imagine. change.

## 7 Additional Functions

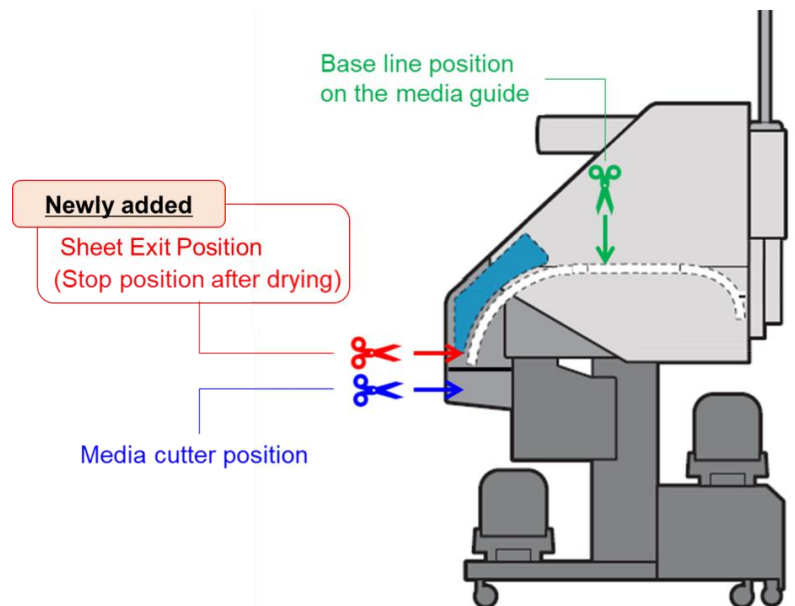



## Additional Functions

### Before You Start

#### How to Read this Manual

This document describes additional functions of the new firmware for RICOH Pro L5130/5160.

System : 2.01 or later

Engine : 2.01:01 or later

Updating firmware of the machine should be performed by a customer engineer.  
Contact your service representative if you need.

## Additional Functions

### Manually Input the Right-side Edge Position and Width of Media

#### How to Input Manually

##### [Overview]

This section explains the procedures for entering the right-side edge position and width of media by control panel.

Use this function when the right-side edge position and width cannot be detected automatically, such as black media / transparent media.

##### [How to operate]

1. Press [Standard Procedure] key
2. Press [Media Settings]
3. Press [Auto Detect Media Width]

##### [Setting details]

- **[ON]** : The right-side edge position and width of the media are automatically detected. Please use this normally.
- **[OFF]** : Manually enter the right-side edge position and width of the media when setting the media. Use this function when the right-side edge position and width cannot be detected automatically, such as black media / transparent media.

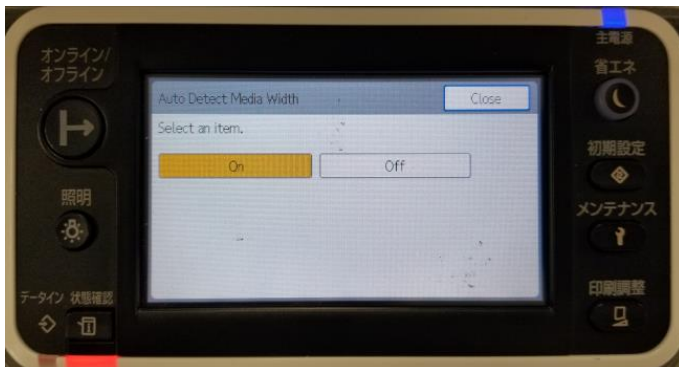
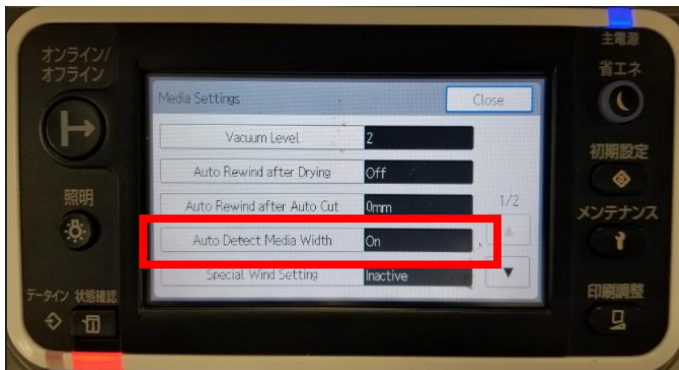

## Additional Functions

### CAUTION

If you enter an incorrect value, ink may be ejected onto the platen without the media. In that case, clean the platen. For cleaning the platen, see the section "Cleaning the Platen" in the manual "Requests for Daily Care and Maintenance".

When [Auto Detect Media Width] is set to [Off], set the right-side edge position and width manually.

Press [Next] to set [Media Right Side Edge Position] and [Media Width].

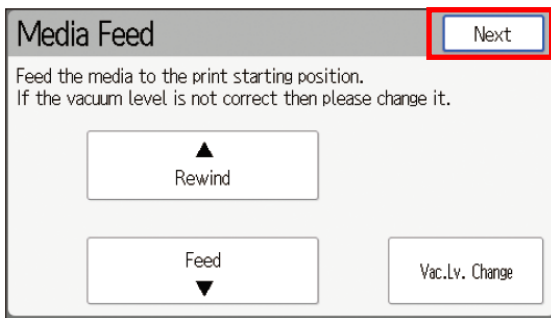

In [Media Right Side Edge Position], enter the position of the right-side edge of media with a range of -10 to 10 of the scale on the post-heater.

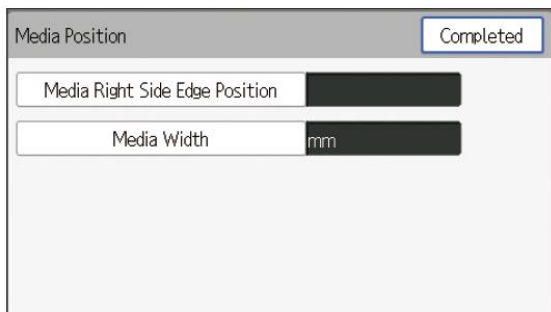

If it is -4 on the post-heater scale, enter "-4".

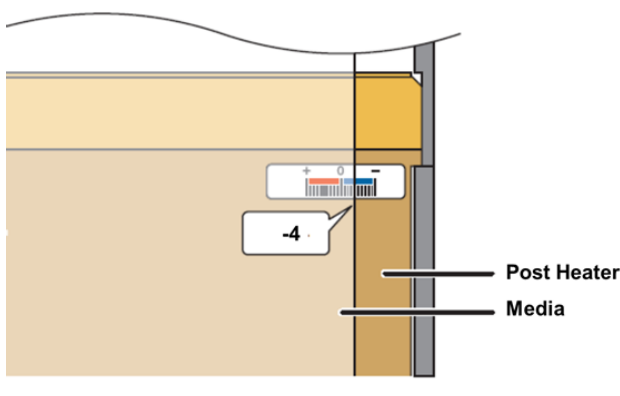

## Additional Functions

In [Media Width], enter the media width a range of 297 to 1,626mm (approx. 11.7 to 64.0inches)(for RICOH Pro L5160) or 297 to 1,372mm(approx. 11.7 to 54.0inches)(for RICOH Pro L5130).

## Additional Drive Mode of Roll-Up Holder

### Changing Roll-Up Drive Mode

#### [Overview]

This section explains the procedures for changing roll-up mode.

The machine can offer two roll-up modes for handling wide variety of media from thin films to thick banners.

Basically, we recommend using "Inactive" drive mode, the default setting, unless there's problem on print quality and/or media feeding.

However, if the media has not been fed and does not come out from the media output location (Cure Heater) and/or the media rises on the platen (see following figure), media feeding behavior may be improved by selecting "Forced Wind" drive mode.

Please use roll-up holder and select appropriate drive mode for improving media misfeed issues.



Fig. Photo and schematic illustration of risen media on the platen.

## Additional Functions

### Tab. Advantages and disadvantages when using "Forced Wind" drive mode.

When using "Forced Wind"...

Advantages	Disadvantages
Media misfeed issues may be improved by rolling up with tensioning using "Forced Wind" drive mode of roll-up holder.	Media skewing and/or floating may occur and print quality may get worse compared to when using "inactive" mode.

#### [How to operate]

1. Press [Standard Procedure] key.
2. Press [▼] and [Media Settings].



3. Press [Special Wind Setting].

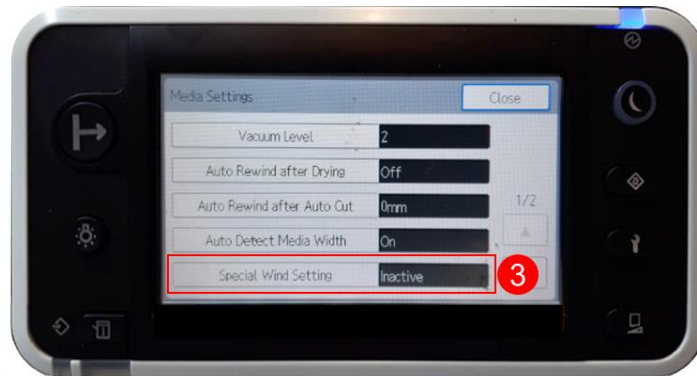

4. Select [Inactive] or [Forced Wind].

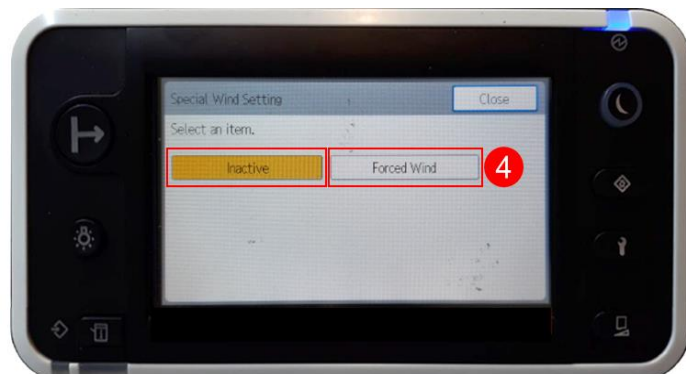

## Additional Functions

- **[Inactive]** : Roll-up holder rotate as intermittent drive (stop and go) with slackening media while printing or feeding. **(Default)**  
\*Basically, we recommend using this mode unless there are problems.
- **[Forced Wind]** : Roll-up holder rotates continuously with tensioning media while printing or feeding.  
\*This mode can improve media misfeed when using thin media such as films.

### ★ Important

- After changing roll-up mode, please re-adjust media feed quantity.  
For details, see "Adjusting the Media Feed Quantity" in the manual "Operating Instructions for RICOH Pro L5130/L5160".
- "Forced wind" roll-up mode is more likely to cause media skewing or floating than "Inactive" roll-up mode.  
If the print quality issues such as "Uneven Density" caused by skewing occur, please use "Inactive" drive mode.  
("Solutions manual for RICOH Pro L5130/L5160" provides the solutions for each print quality issue. Please also refer to it for troubleshooting.)
- The regular print quality cannot be guaranteed when using "Forced wind" roll-up mode.  
If you may not obtain the print result you expect, make sure to use appropriate media.  
For details about appropriate media, see "About Media" in the manual "Operating Instructions for RICOH Pro L5130/L5160".



## Additional Functions

### Additional Drive Mode of Roll Holder

#### Changing Roll Holder Drive Mode

##### [Overview]

This section explains the procedures for changing roll holder drive mode.

The machine can offer two drive modes of roll holder for stable media feeding by loading appropriate back-tension.

Basically, we recommend using "Inactive" drive mode, the default setting, unless there's problem on print quality and/or media feeding.

However, when using the media that easily sticks to print and back surfaces each other (see the following figure), the print quality and media feeding behavior may be improved by selecting "Forceless Feed" drive mode.

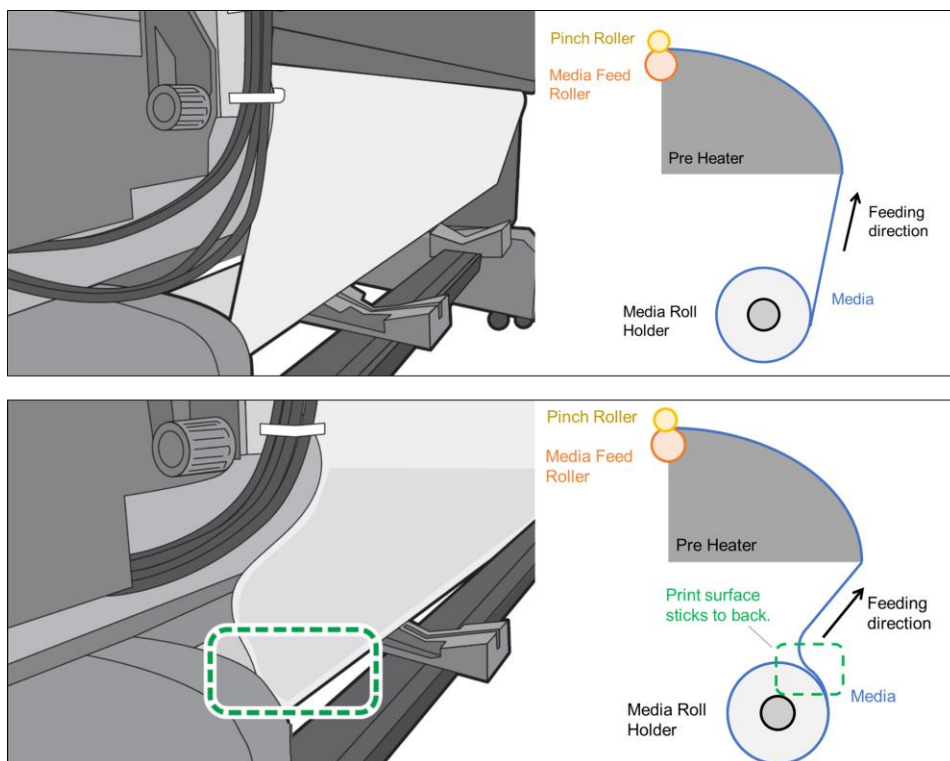

Fig. Schematic illustration of normal media feeding behavior (above) and sticking print and back surface of media (below).

## Additional Functions

Tab. Advantages and disadvantages when using "Forceless Feed" drive mode.

When using "Forceless Feed"...

Advantages	Disadvantages
Media feeding behavior and print quality may be improved when using sticky media.	Media skewing and/or floating may occur and print quality gets worse when using "ordinary" media (not sticky media).

### Additional Drive Mode of Roll Holder

[How to operate]

1. Press [Standard Procedure] Key.
2. Press [▼] and [Media Settings].



3. Press [▼] and [Special Feed Setting]

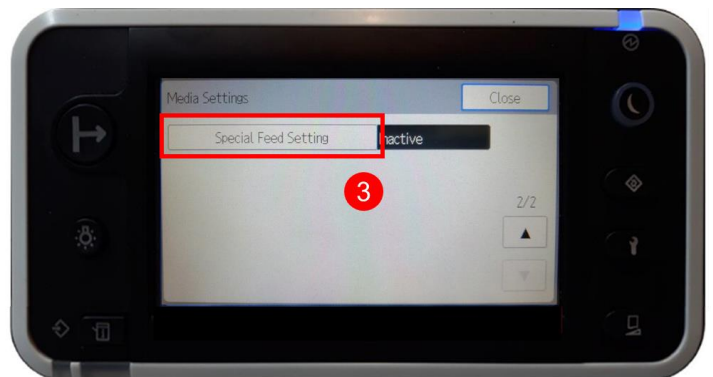

4. Select [Inactive] or [Forceless Feed].

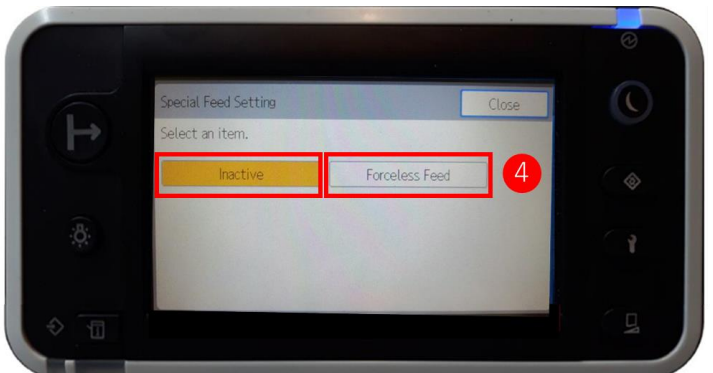

## Additional Functions

- **[Inactive]** : Roll holder rotate as intermittent drive (stop and go) with loading back tension to the media while printing or feeding. (Default)

\*Basically, we recommend using this mode unless there's problem.

- **[Forceless Feed]** : Roll holder does not drive and not load back tension to the media while printing or feeding.

\*This mode can improve uneven back tensioning caused by stickiness of media surfaces.

### ★ Important

- After changing roll holder drive mode, please re-adjust media feed quantity.  
For details, see "Adjusting the Media Feed Quantity" in the manual "Operating Instructions for RICOH Pro L5130/L5160".
- "Forceless Feed" roll holder drive mode is more likely to cause media skewing or floating than "Inactive" drive mode when using ordinary media (not sticky media).  
If the print quality issues such as "Uneven Density" caused by skewing occur, please use "Inactive" drive mode.  
("Solutions manual for RICOH Pro L5130/L5160" provides the solutions for each print quality issue. Please also refer to it for troubleshooting.)
- In case of sticking on the roll media and not obtaining print quality you expect, please pull out the media once and wind it around the roll core again.  
Please see "Uneven density (Media is stuck on the platen)" in the manual "Solutions manual for RICOH Pro L5130/L5160".
- The regular print quality cannot be guaranteed when using "Forceless Feed" drive mode. If you may not obtain the print result you expect, make sure to use appropriate media. For details about appropriate media, see "About Media" in the manual "Operating Instructions for RICOH Pro L5130/L5160".

## Additional Functions

### New Cut Position

#### How to Select the Cut Position

##### [Overview]

This section explains how to cut roll media, especially, newly added cut position.

The machine can offer three position where to cut media from either [Sheet Exit Position], [Position of the cutter] or [Base line position on the media guide].

The newly added [Sheet Exit Position] can eliminates the need for media feeding by manually when cutting media after drying by cure heater.

##### [How to operate]

1. Press [Origin Setting/Cut] on the bottom right of the screen.



2. Press [Cut].



## Additional Features

### New Cut Position

3. Select the position from where to cut media from either [Sheet Exit Position], [Position of the cutter] or [Base line position on the media guide].

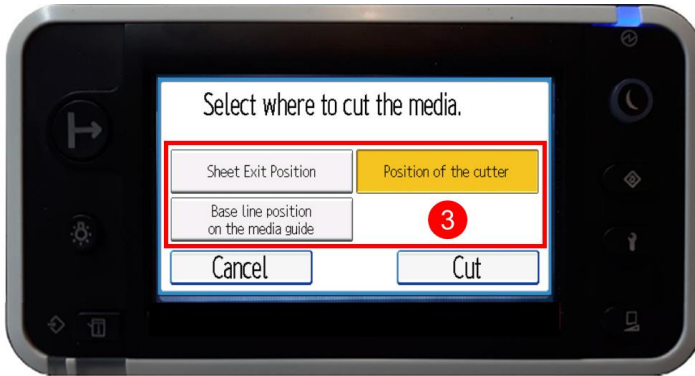

4. Press [Cut].  
Start cutting at the cut position that you set.

\* When [Sheet Exit Position] is selected, media is automatically fed from sheet exit position to the media cutter position (about 60mm length) before starting to cut.  
-> Media is cut at the position indicated as red arrow in following figure.

\* When [Position of the cutter] is selected, cutting start without media feeding.  
-> Media is cut at the position indicated as blue arrow in following figure.

\* When [Base line position on the media guide] is selected, media is automatically fed from "scissor mark" on the media guide to the media cutter position (about 630mm length) before starting to cut.  
-> Media is cut at the position indicated as green arrow in following figure.

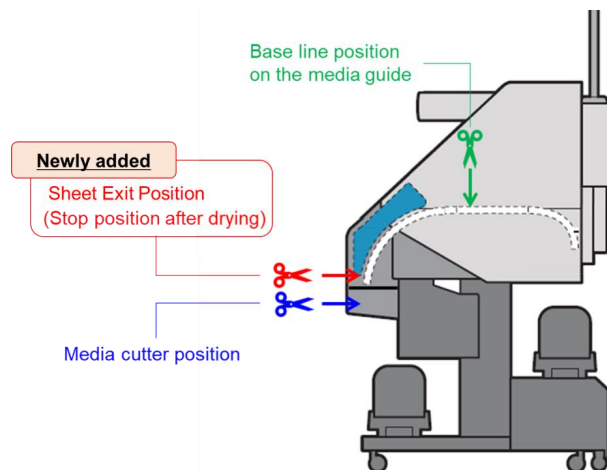

5. Press [Set].

## Additional Features

### Improved Control Panel Operability

#### Checking Status during Maintenance or Adjustment

##### [Overview]

- Heater temperature setting and current temperature can be checked in [Check Status].
- During maintenance or adjustment, [Check Status] can be performed.

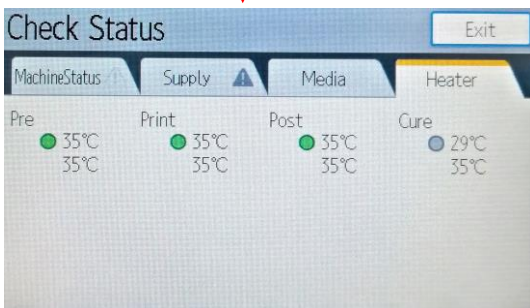
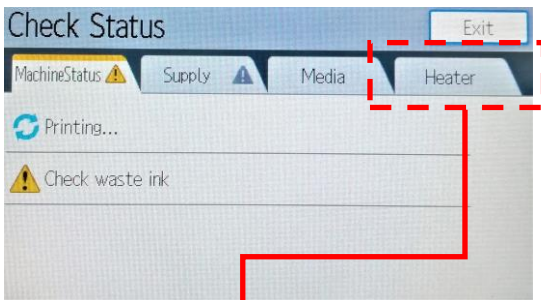

##### **New Software**

System : 2.01 or later

Engine : 2.01:01 or later

##### **Reference**

- See page "Checking Machine Status and Settings" in the manual "Operating Instructions".

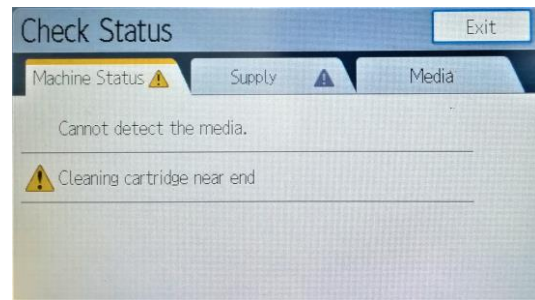

##### **Old Software**

System : 1.07 or earlier

Engine : 1.08:01 or earlier

## Additional Functions

### [How to operate]

\*For example, in case of Media feed adjustment

1. Execute the Media feed adjustment.
2. Displays a message on the control panel.

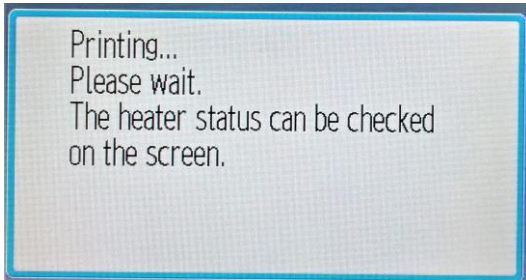

3. Press [Check Status]

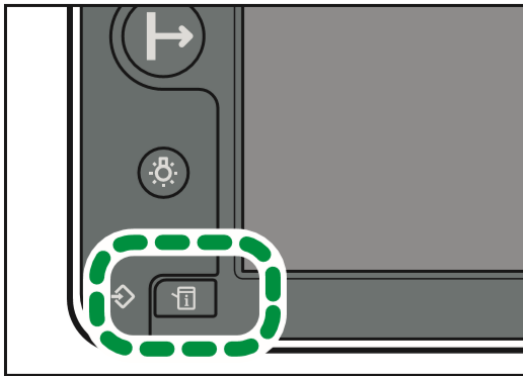

4. Displays the Status

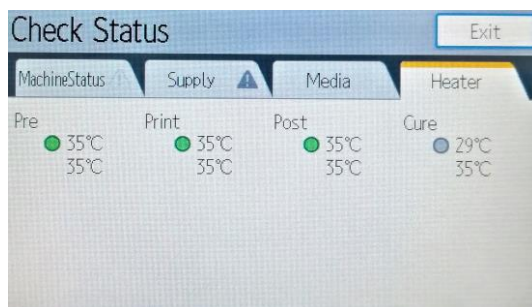

## Additional Functions

### Modified the Connection Method

#### [Overview]

This section explains procedures for connection methods to reduce image quality defects such as black lines.

This operation method has been changed to a simpler form than the previous one.

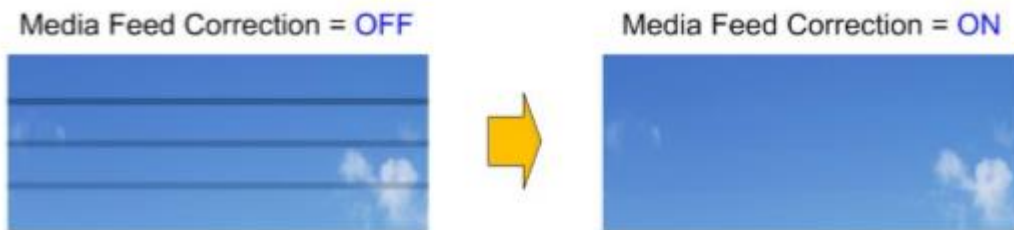

#### Points of Changes

- Removing [ON/OFF] key in "Media Feed Correction" menu
- Removing "Print Head Alignment" menu
- Limiting items which can be set for each print mode setting

#### Reference

- See page 107-112 in the manual "Operating Instructions"
- See page 12-14 in the manual "Solution manual"

#### [How to operate]

1. Press the [Standard Procedure] key

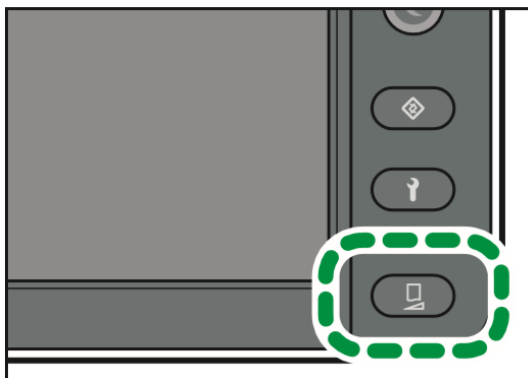



# CIP Training L5160/L5130

## Additional Functions

2. Press [Print Mode Settings] key
3. Select Print Mode

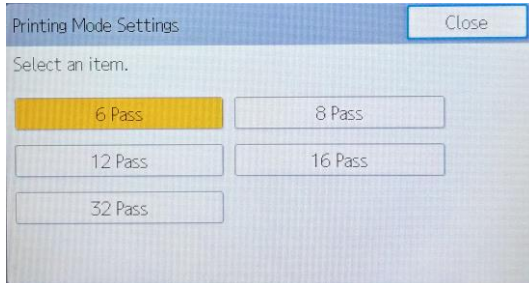

Ink Combinations: 4C

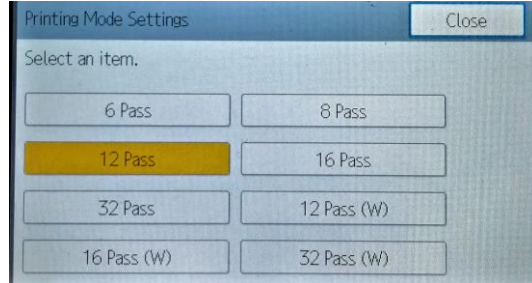

Ink Combinations: 4C+W

4. Press [▼] key
5. Press [Media Feed Correction] key
6. Select the Media feed correction level

### - Ink Combinations: 4C

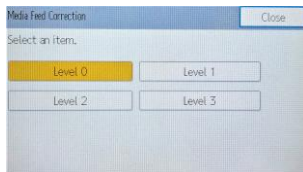

Print Mode: 6/8/12/16 Pass



Print Mode: 32 Pass

### - Ink Combinations: 4C+W

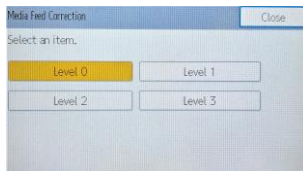

Print Mode: 6/8 Pass

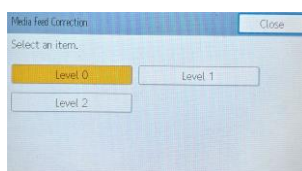

Print Mode: 12 Pass



Print Mode: 16/32 Pass

12(W)/16(W)/32(W) Pass

7. Press End

## Additional Functions

### [Setting details]

Setting	Description
Level 0	Media feed correction does not work (Default Setting)
Level 1	Media feed correction works
Level 2	Stronger than level 1
Level 3	Stronger than level 1 and level 2

#### ★ Important

- Media feed correction is used when black lines appear after performing [Media Feed Adjustment] - [Micro Setting] / [Level Setting].
- If black lines are found, set to [Level 1].  
If the black lines do not disappear after the setting has been changed, set to [Level 2] or [Level 3].
- If Media feed correction is too strong, the white band may occur.

## Additional Functions

### Modified the Print Mode Selection

#### How to Select the Print Mode

##### [Overview]

The method of selecting the print mode has been changed. Media feed adjustment and Drop position adjustment is executed with the selected print mode when executing these adjustments. Similarly, Micro setting and Media feed correction are set to the corresponding print mode.

When media record is retrieving, the adjustment value and print settings are switched to the value that corresponding to the selected print mode.

Save time to heat the heater with select the print mode used to the next job in advance.

1. Press the [Standard Procedure] key.

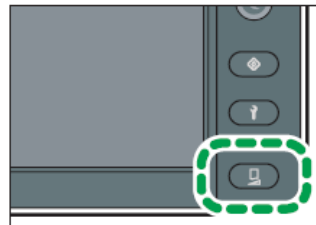

2. Press [▼].
3. Press [Print Mode Settings].



4. Select print mode used to the next job.

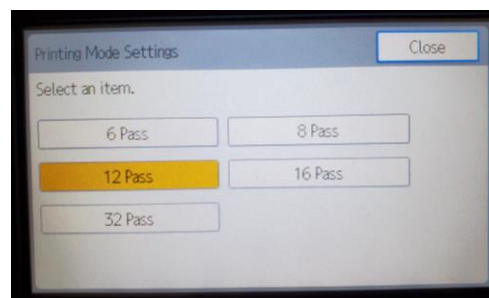

\* If 4C+W device, [12 Pass (W)], [16 Pass (W)], and [32 Pass (W)] are displayed.

Ink Combinations: 4C

##### ★ Important

If selected print mode is different between machine and RIP software, print mode setting on the machine is overwritten when starting job.

## Additional Functions

### Enhanced Media Records

#### Overview

With the media record function, you can register / retrieve the setting related to the media such as Media type, Media thickness...etc., and the print settings for each print mode such as Media feed adjustment value, Drop position adjustment value, Heater temperature... etc.

The image quality can be stabilized by always using the optimum setting.

In addition, it is possible to omit adjustments each time, which saves time and waste media.

#### CAUTION

The parameters that can be registered have expanded with new firmware\*, so after updating the firmware, please re-register all media records with this new procedure.

See the section "Edit" in this manual for details.

\*New firmware is described in the section "Before You Start".

#### Important

- Strongly recommend adjusting the "Media Feed Adjustment" by each job or roll.
- 30 settings can be registered in the machine. Register for each product of media is recommended.

## Additional Functions

### [Parameters to be recorded]

Parameters	Note	Firmware
Media shape	-	-
Media type	-	-
Media width	-	-
Media thickness	-	-
Head height	-	-
Vacuum level	-	-
Auto detect media width - ON/OFF	-	*2 New
Auto detect media width - right side edge/width	-	*2 New
Special feed settings	-	*2 New
Special wind settings	-	*2 New
Drop position adjustment value	*1 Each print mode	-
Media feed adjustment value	*1 Each print mode	-
Media feed adjustment - Micro setting	*1 Each print mode	*2 New
Media feed correction	*1 Each print mode	*2 New
Heater ON/OFF	*1 Each print mode	*2 New
Heater temperature (Pre/Print/Post/Cure) *3	*1 Each print mode	*2 New

(\*1) These parameters are recorded for each print mode

(\*2) These parameters can be recorded by new firmware described in the section "Before You Start"

(\*3) The temperatures are saved when executing Media feed adjustment or Drop position adjustment.

## Additional Functions

### Register

#### ★ Important

The optimum adjustment value differs for each product of media.

It is recommended to save the print settings and adjustment value for each product of media.

#### [Preparation for registration]

1. Load the media and set following parameters.  
Media shape (outer /inner) Media type, Media thickness, Head height, Vacuum level.
2. Press [Standard Procedure] key.
3. Press [Print Mode settings] and select print mode from [6 Pass], [8 Pass], [12 Pass], [16 Pass], and [32 Pass].  
In the case of 4CW machines, select from [6 Pass], [8 Pass], [12 Pass], [16 Pass], [32 Pass], [12 Pass (White)], [16 Pass (White)], and [32 Pass (White)].
4. Set the Heater temperature used actual print.  
Confirm the heater temperature with Rip software and set to the control panel.
5. Set the following parameters.  
Auto Detect Media Width - ON/OFF, Right-side Edge, Width, Special wind settings, Special feed settings.  
See the following sections for detail.
  - "Manually Input the Right-side Edge Position and Width of Media"
  - "Additional Drive Mode of Roll-Up Holder"
  - "Additional Drive Mode of Roll Holder"
6. Press the [Media Feed Adjustment] and select [Auto] or [Manual].  
Execute the Media feed adjustment.
7. Press the [Drop Position Adjustment] and select [Auto] or [Manual].  
Execute the Drop position adjustment.
8. Print the actual image and optimize [Micro Setting] and [Media Feed Correction]. See the section "Modified the Connection Method" for detail.

#### [How to operate]

9. Press the [Standard Procedure] key.

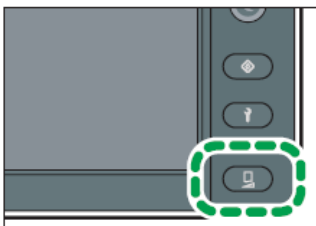

## Additional Functions

10. Press [▼].
11. Press [Media Records Register / Retrieve].
12. Press [Media Records Register].
13. Press [▲] or [▼] to select the number you want to register.
  - Selectable numbers are from 01 to 30.

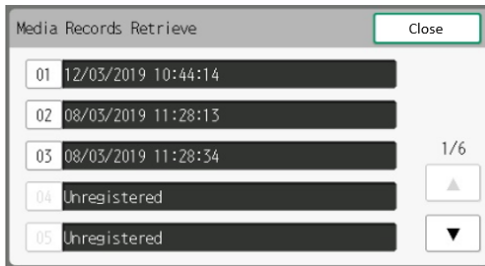

14. Press Enter.
15. Select the print mode you adjusted in advance to register from [6 Pass], [8 Pass], [12 Pass], [16 Pass], and [32 Pass]. in the case of 4CW machines, select from [6 Pass], [8 Pass], [12 Pass], [16 Pass], [32 Pass], [12 Pass (White)], [16 Pass (White)], and [32 Pass (White)].
  - It can be possible to select Multiple print modes.
  - When registering all adjustment values, press [Register All Modes].

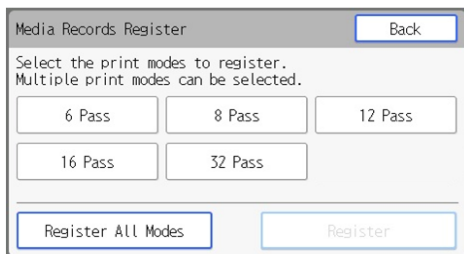

16. Press [Register]. This step is omitted when [Register All Modes] is selected.
17. Press Enter.
  - Adjustment values of selected print mode are registered.
  - Date and time are displayed in the order of day/month/year time: minute: second.
  - The registration date and time are updated when registered values are overwritten or another adjustment value is added.
18. Press [OK].
19. Press [Exit].

## Additional Functions

### Rename

Rename the media record registered.

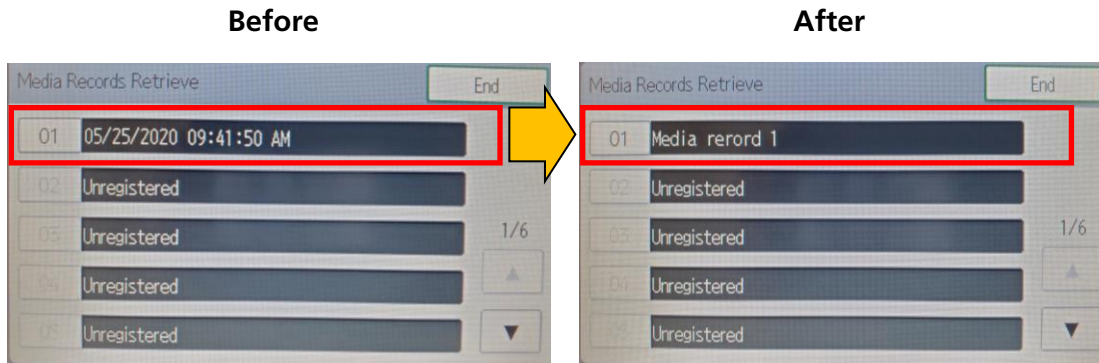

#### [How to operate]

1. Move the Home screen on control panel on the printer. Confirm "Ready" is displayed.  
\*If Printer is Online or Job data is in, rename will fail.



2. Access the Web image monitor.  
Start your web browser.  
Enter "http://(machine's IP address or host name)/" in your web browser's URL bar. See the section "Using Web Image Monitor" in the manual "Operation Instructions" for detail.
3. Click the [Machine settings].

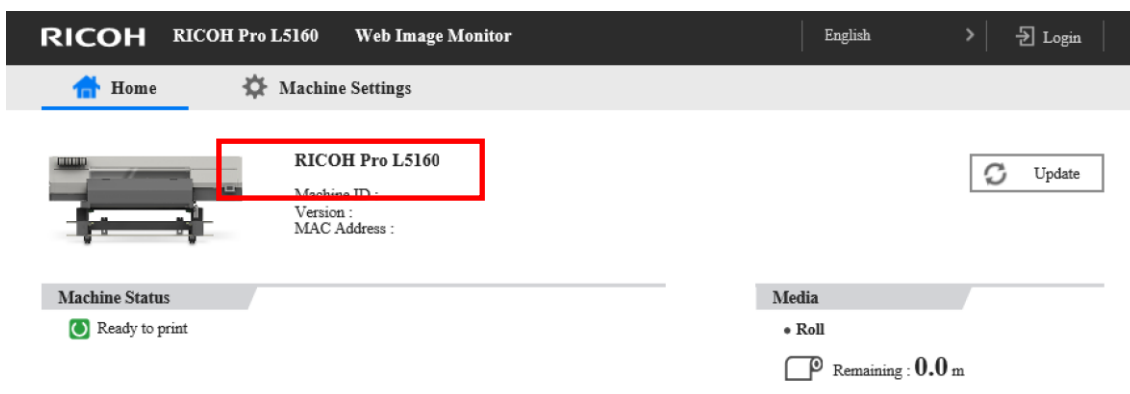



## Additional Features

### 4. Click the [media records].

The screenshot shows the RICOH Web Image Monitor interface. The top navigation bar includes 'RICOH RICOH Pro L5160 Web Image Monitor', 'English', and 'Login'. The main menu has 'Home' and 'Machine Settings'. The 'Machine Settings' page is active, showing 'Interface Settings' with an 'Update' button. The left sidebar lists various settings: Interface, Network, and Machine. The 'Media Records' option under the Machine section is highlighted with a red box.

### 5. Fill the name of media in the box for Registration Names. (Red box in figure)

### 6. Click [Save settings]

The screenshot shows the 'Machine Media Records' page. It features a table with the following data:

	Registration Name	Media Shape	Media Type	Print Mode (Pass)	
01	Test	Roll (Outer winding of print side)	Plain Paper	12	Details
02	4/9/2020 11:53:11 AM	Roll (Outer winding of print side)	PVC	12/16	Details
03	3/12/2020 4:06:01 PM	Roll (Outer winding of print side)	Coated Paper	12	Details
04	3/12/2020 4:06:09 PM	Roll (Outer winding of print side)	Coated Paper	16	Details
05	3/12/2020 4:06:15 PM	Roll (Outer winding of print side)	Coated Paper	32	Details
06	3/12/2020 4:06:21 PM	Roll (Outer winding of print side)	Coated Paper	6/8/12/16/32	Details
07	4/9/2020 6:18:12 PM	Roll (Outer winding of print side)	PVC	16	Details
08	Unregistered	-	-	-	

A 'Save settings' button is located at the bottom right of the page, highlighted with a green box.

### [Note]

If "Online", "Cannot detect media", or "Data in" is displayed on the home screen on the control panel when click [Save settings], the following error occurs.

Make sure that "Ready" is displayed and try again.



The machine information is in use by another function. Please try again later.

## Additional Functions

### Retrieve

Describing the procedure to retrieve the registered print setting when changing or re-setting the media.

#### [How to operate]

1. Set the media.
2. Lower the media lock lever.

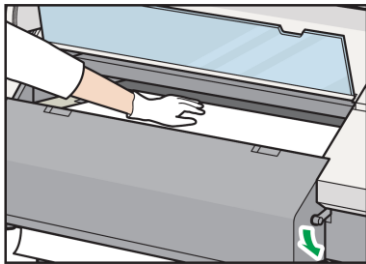

3. Press [Yes].

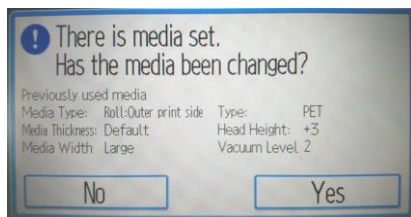

4. Press [Yes].

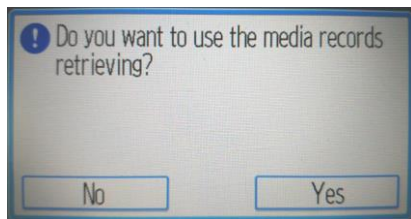

5. Press [▲] or [▼] to select the number.

- The number displayed as [Unregistered] cannot be selected.

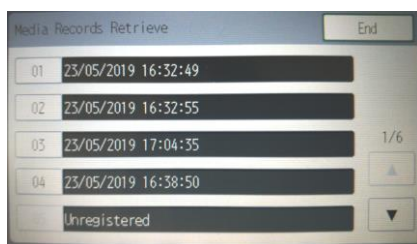

## Additional Functions

### 6. Press [Execute].

- The media record registered in advance is retrieved.



### 7. Press [Confirm].



### 8. Press [Print Mode settings] and select print mode used for the next job.

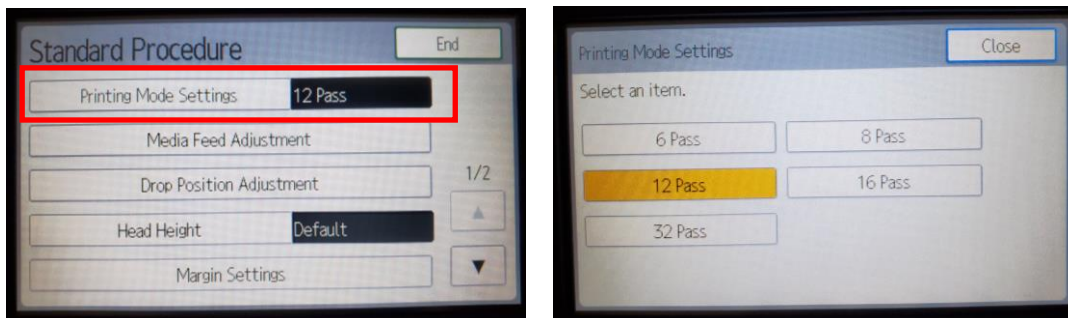

Following parameters are registered for each print mode.

These are retrieved when print mode is selected.

Parameters
Drop position adjustment value
Media feed adjustment value
Media feed adjustment - Micro setting
Media feed correction
Heater ON/OFF
Heater temperature

### 9. Execute the Media feed adjustment to improve the image quality.

\*Set the Auto rewind settings if necessary.

## Additional Functions

### Edit

Describing the procedure of

- Overwriting the record data that already registered.
- Add another print mode setting to the registered media record.

#### [How to operate]

1. Retrieve the number of the media record.
2. Edit the parameters following procedure.

#### ★ Important

The heater temperatures are saved when performing Media feed adjustment or Drop position adjustment. If the heater temperature is changed, execute Media feed adjustment and Drop position adjustment before register.

Regarding "Order to set" in the table below, if the parameters of No.1 are changed, follow the procedure of No.2, 3 and 4 again and optimize the parameters of No.2, 3 and 4. Similarly, if parameters of No.2 are changed, follow the procedure of No.3 and 4 again and optimize the parameters of No.3 and 4.

Parameters	Procedure	Order to set
Media shape	These parameters are not able to edit after registered. Please register again following the section of "Register".	-
Media type		
Media width		
Media thickness		
Heater ON/OFF	1. Move to Home screen. 2. Press [Heater setting] and change settings.	No.1
Heater temperature		
Head height	1. Press [Head height] and change setting. 2. Select the parameter to edit and change setting.	No.2
Vacuum level		
Auto detect media width - ON/OFF		
Auto detect media width - right side edge/width		
Special feed settings		
Special wind settings		

## Additional Functions

### Enhanced Media Records

Drop position adjustment value	1. Press [Print Mode Settings] and select mode. 2. Press [Drop Position Adjustment] / [Media Feed Adjustment]. 3. Select [Auto] or [Manual] and execute.	No.3
Media feed adjustment value		
Media feed adjustment - Micro setting	1. Press [Print Mode Settings] and select mode. 2. Press [Media Feed Adjustment]. 3. Press [Micro Setting] / [Media Feed Correction]. 4. Change settings. See the section of "Modified the Connection Method" for detail.	No.4
Media feed correction		

### 3. Restart from the step 9 in the section "Register".

#### [Note]

The warning message is displayed in the following cases.

- The media record has not been retrieved.
- The retrieved media record number and the media record number selected to register are different.

When warning message is displayed, select [No] and retrieve the media record number that you want to overwrite or add data, then register again.

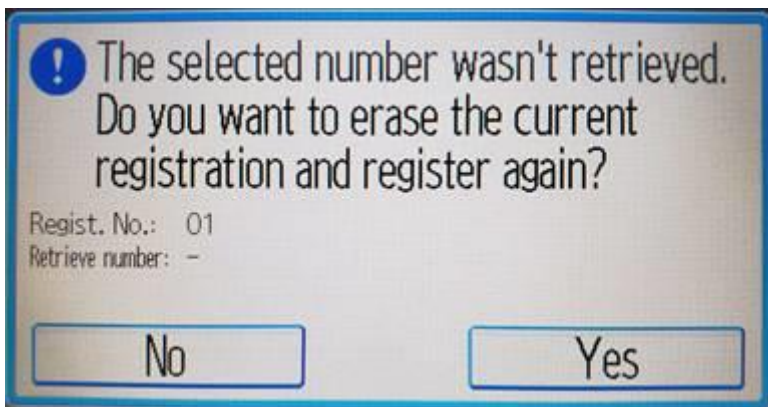

If [Yes] is selected, data such as media settings and adjustment values in the selected media record number are deleted and the current data set in the machine are newly registered to the selected media record number.





**RICOH**  
imagine. change.