

CIP Training

Pro C9200 series

1 Input

RICOH
imagine. change.

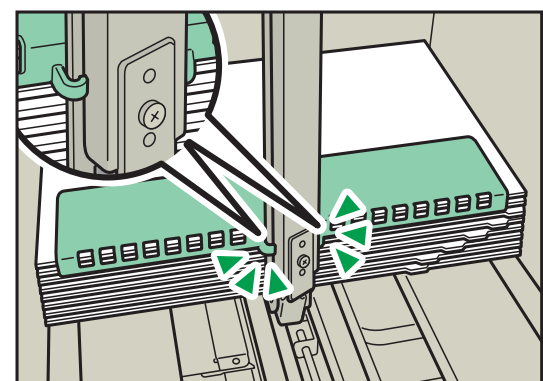
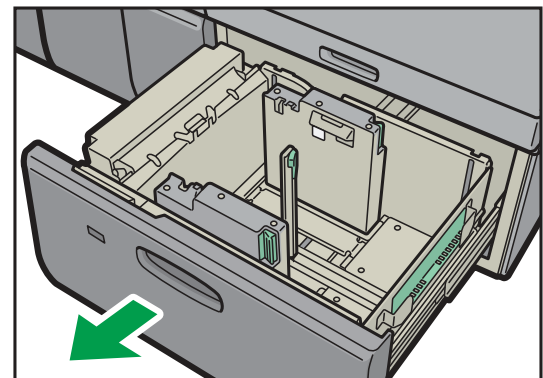
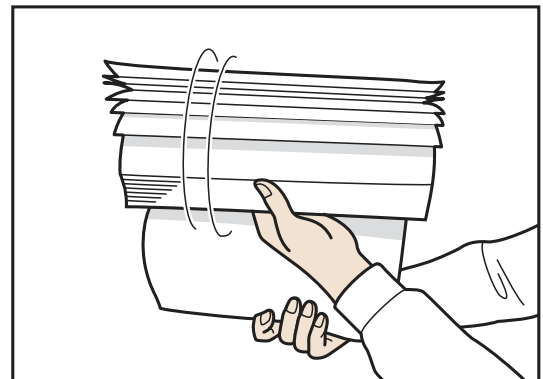

CIP Training Pro C9200 series

Loading Paper

★ Important

- **Do not stack paper over the limit mark**

Jams and misfeeds can occur when printing on thick glossy sheets. To prevent such problems, be sure to fan glossy sheets thoroughly before loading them.

When loading paper, set the paper direction according to its grain, as shown in the following diagram:

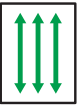
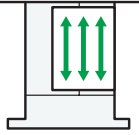
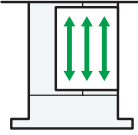
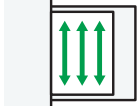
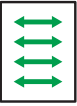
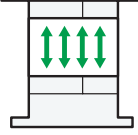
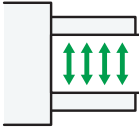
| Direction of paper grain | Tray 1 | A3/11 × 17 tray unit, Tray 2, or the wide LCT | Multi bypass tray (Tray A) |
|--|---|--|--|
|  |  |  |  |
|  | Not recommended |  |  |

↓ Note

- Even if paper is loaded as described above, normal operations and print quality might still not be possible, depending on the paper type.
- Prints might be noticeably curled. Flatten out prints if they are creased or curled. For details about settings for flattening out curled paper, see 0301 0303 Correct Output Paper Curl , Maintenance and Management.
- To prevent multiple sheets from being fed at once, fan the paper before loading it.
- If you load paper when only a few sheets of paper remain in the tray, multiple sheet feeding may occur. Remove any remaining paper, stack them with the new sheets of paper, and then fan the entire stack before loading it into the tray.
- Straighten curled or warped paper before loading.
- When paper in trays that are set to automatically eject unnecessary tab stock sheets runs out, reload the tab stock from the beginning of the cycle (the first sheet).
- When you load paper into the paper tray for the first time or when you change the size or type of paper in the paper tray, be sure to specify the appropriate paper settings in Tray Paper Settings.
- You might at times hear a rustling noise from paper moving through the machine. This noise does not indicate a malfunction.

CIP Training Pro C9200 series

Loading Paper

1. Loosen the stack by riffling the sheets.

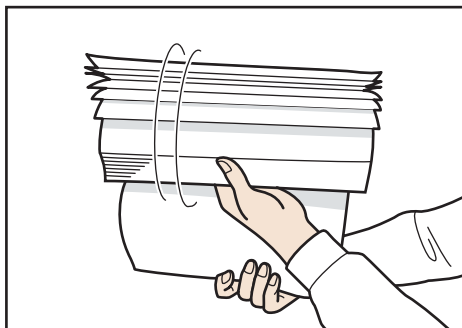

CVA068

2. Holding its shorter ends, flex the stack back and forth to create space between the sheets. Repeat this several times.

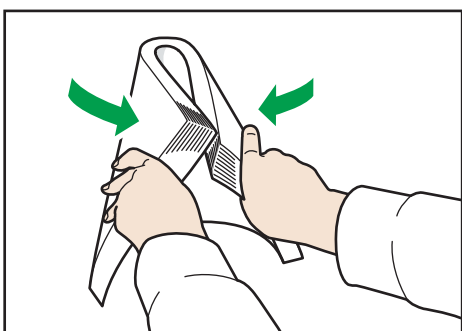

CVA069

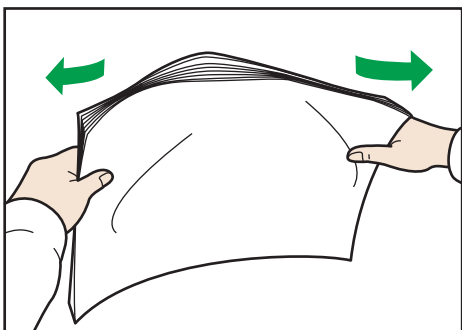

CVA070

3. Make sure there is space between the sheets.

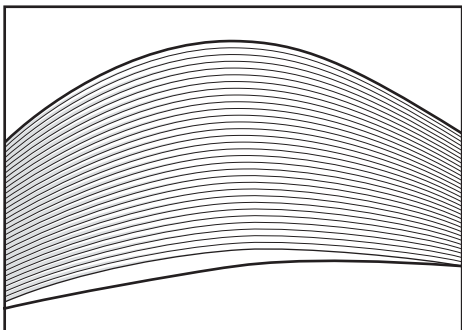

CVA071

CIP Training Pro C9200 series

Loading Large Capacity Trays

Loading Paper into Trays 1, 2, and the Wide Large Capacity Tray

Each paper tray is loaded in the same way.

The wide LCT is identified as Tray 3, Tray 4, Tray 5, Tray 6, Tray 7, and Tray 8.

★ Important

Check the paper edges are aligned at the left side.

When you use paper of Paper Weight 7 with a convex curl greater than 5 mm, paper of Paper Weight 8 with a convex curl greater than 3 mm, or paper of Paper Weight 9 with a convex curl, paper jam may occur if the height of the stacked paper is less than 4 mm. To use paper in such condition, set the paper in the tray as follows:

- Set as many as 5 to 10 more sheets than the number you intend to print
 - Correct the curl amount before setting the paper
 - Turn over the paper so the paper is with a concave curl.
-

CIP Training Pro C9200 series

Loading Large Capacity Trays

Step: 1

Check that paper in the paper tray is not being used, and then pull the tray carefully out until it stops.

Remove paper if loaded.

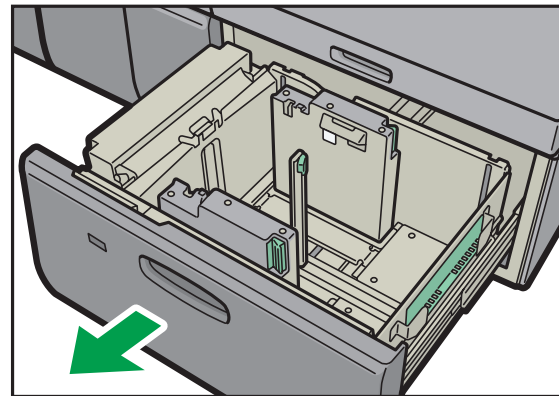

Step: 2

Release the end fence by pressing and holding green button. Move to back of tray.

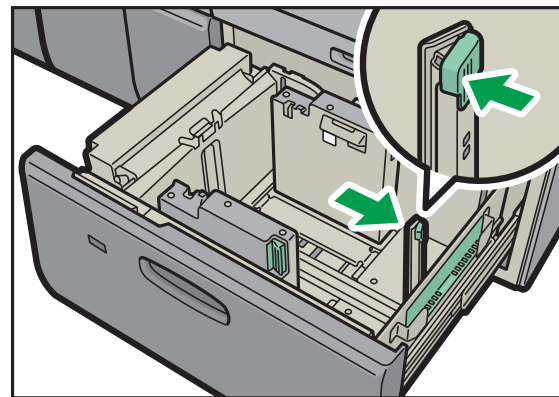

Step: 3

Release the side fence by pressing and holding both green buttons together. Move side fences to maximum width of tray.

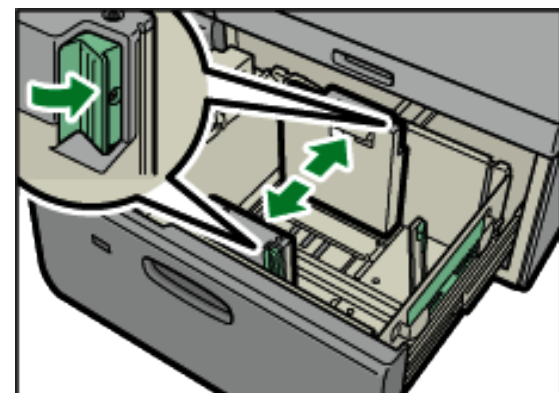

M95200101

CIP Training Pro C9200 series

Loading Large Capacity Trays

Step: 4

Load paper by aligning the paper with the left side of the paper tray.

Place paper with print side up.

Load a stack of paper about 5–10 mm high.

Make sure the paper rest on top of the supporting plates on both sides.

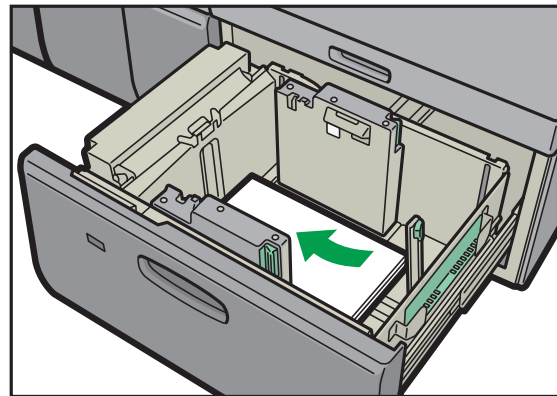

Step: 5

Load additional sheets, if necessary.

Do not stack paper over the limit mark.

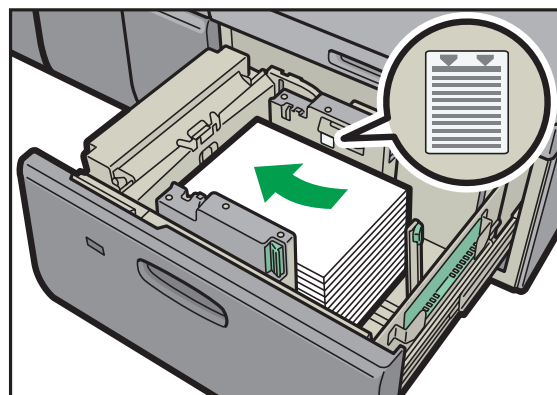

Step: 6

Tightly fit the end fence to the loaded paper, and then re-lock the end fence again.

Make sure there are no gaps between the paper and end fence.

Carefully slide the paper tray fully in.

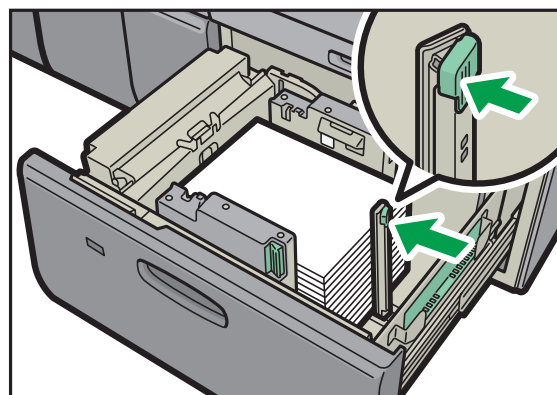

CIP Training Pro C9200 series

Loading Large Capacity Trays

When loading small stock.

When you load paper that is 204 mm or smaller, remove the supporting plates from the bottom of the paper tray.

Store them in the pocket on the right-hand side of the paper tray.

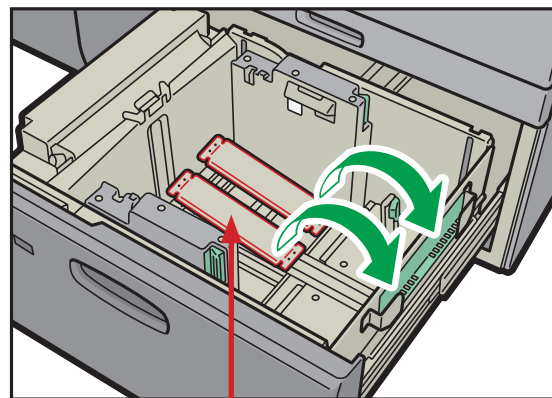

Supporting plates

Set the paper flush against the protrusions in the bottom of the inner side fence.

Check that the scale numbers on the top of the side fences are roughly the same.

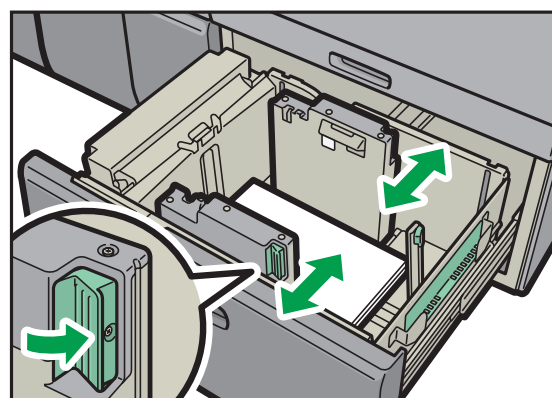

Specifications.

Capacity: 2,200 sheets. (Capacity using 80 gsm uncoated paper)

| | | |
|---------|------------------------------------|------------------------------------|
| Weight: | Paper weight 1: 52.3 to 63.0 gsm | Paper weight 6: 220.1 to 256.0 gsm |
| | Paper weight 2: 63.1 to 80.0 gsm | Paper weight 7: 256.1 to 300.0 gsm |
| | Paper weight 3: 80.1 to 105.0 gsm | Paper weight 8: 300.1 to 360.0 gsm |
| | Paper weight 4: 105.1 to 163.0 gsm | Paper weight 9: 360.1 to 470.0 gsm |
| | Paper weight 5: 163.1 to 220.0 gsm | |

Type: Plain paper, Recycled paper, Uncoated papers, Coated matt and glossy paper, Preprinted paper, Letterhead, Labels, Pre-punched paper, Tab stock, Envelopes, Translucent paper, Textured, Transparency, and other special and synthetic materials as defined in the Master Library.

CIP Training Pro C9200 series

Loading Large Capacity Trays

When loading tab stock, attach the tab fence.

Step: 1

Check that paper in the paper tray is not being used, and then pull the tray carefully out until it stops.

Take out the tab fence from the pocket on the right-hand side of the paper tray.

Set the side fences to the size of the tab stock to be loaded, and then load it.

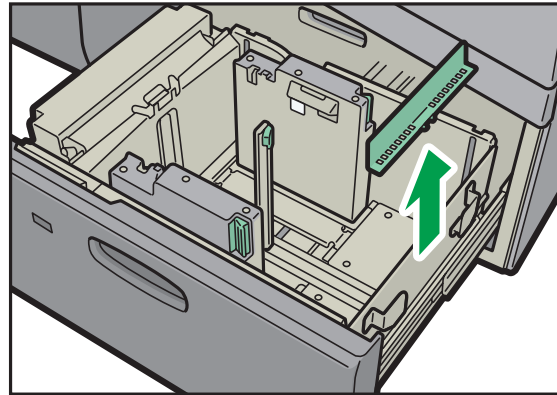

Step: 2

Attach the tab fence, and then align the end fence gently against the paper you loaded while pressing the release button of the end fence.

Carefully slide the paper tray fully in.

NOTE: Replace the tab fence after use.

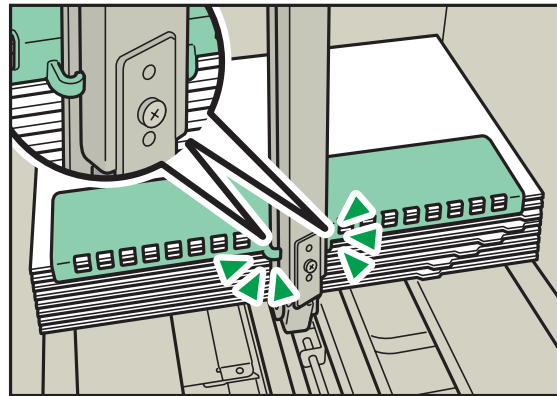

CIP Training Pro C9200 series

Loading Paper into the Multi Bypass Tray (Tray A)

Use the multi bypass tray (Tray A) to use transparencies, translucent paper, and paper that cannot be loaded in the paper trays.

★ Important

- The maximum number of sheets you can load at the same time depends on paper type. Do not stack paper over the limit mark. For the maximum number of sheets you can load.
- Check the paper edges are aligned at the left side.
- When loading a low number of sheets, be sure not to secure the side fences in too tightly. If the side fences are secured too tightly against the paper, the edges may crease, the paper may misfeed, or if it weighs between 52.3–63.0 g/m² (14.0–16 lb. Bond), it may wrinkle.

Step: 1

Set the side fences to the paper size, and then secure the paper and load it print side up.

Do not stack paper over the limit mark.

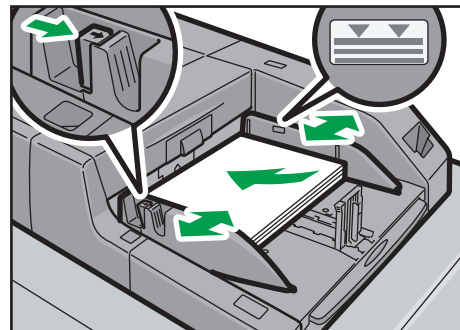

Step: 2

Set the end fence.

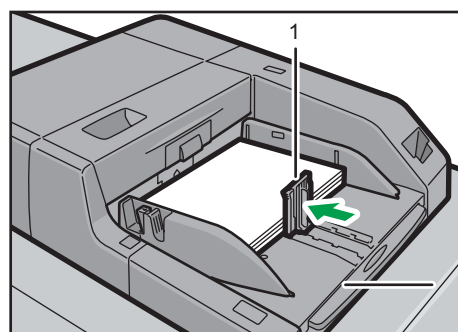

1. End fence
2. Extender

CIP Training Pro C9200 series

Loading Paper into the Multi Bypass Tray (Tray A)

To remove the end fence, slide it to the right by pressing the stopper down.

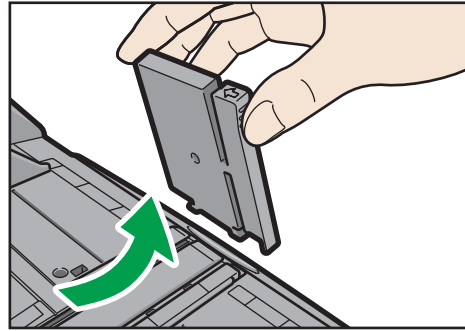

Step: 3

Press the elevator switch on the multi bypass tray (Tray A).

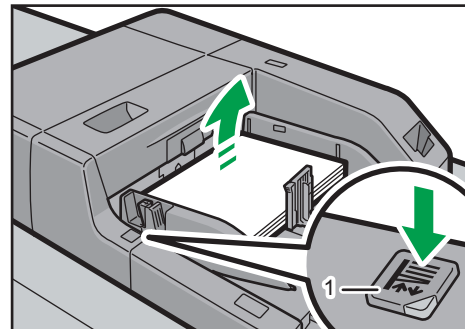

1. Elevator switch

The lamp of the elevator switch is blinking while the tray is going up, and keeps lit when it stops. Press the elevator switch to move down the tray if you want to either add paper or remove jammed ones.

Note

- Pull the extender out when loading 4 or larger sheets in the multi bypass tray (Tray A).
- Letterhead paper must be loaded in a specific orientation.
- You can load envelopes into the multi bypass tray (Tray A). Envelopes must be loaded in a specific orientation.
- Specify the sizes of paper that are not automatically detected. For details about the sizes that can be detected automatically.

CIP Training Pro C9200 series

Loading Paper into the Multi Bypass Tray (Tray A)

Loading tab stock into the multi bypass tray (Tray A)

When setting tab stock, always use the tab fence. Tabs must be set at the right side of the multi bypass tray (Tray).

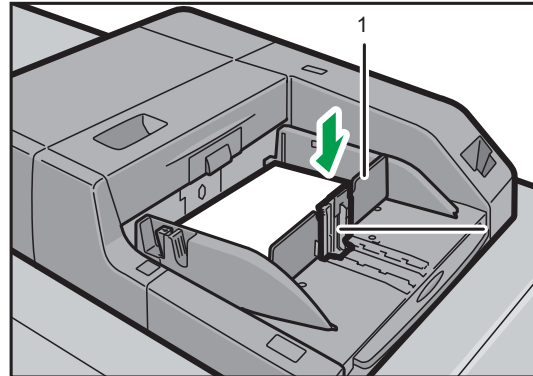

DER073

1. Tab fence
2. End fence

RICOH
imagine. change.